

*Dry or Wet Application***ADVICE**

- All surfaces must be considered dirty and be cleaned prior to application. Possible surface contaminants include dust, rust, migratory components of paint and plastics, chalk lines, grease and oil from hands and other sources, as well as caulking compounds.
- Be sure your cleaner does not contain anything like cream or lotion that could leave residue.
- Air and surface temperature must be between 10 to 35 degrees Celsius for adhesive to set.
- **Decal will require 72 hours for adhesive to fully set. Longer if using Wet Application.**
- **DO NOT pressure wash decal until adhesive has fully set.**

SURFACE PREPARATION

- **Plastic & Glass Surface:** Clean with water and a mild detergent. Next, wipe the surface with Isopropyl Alcohol or Windex. Wipe dry with a lint-free cloth.
- **Painted Surfaces (Metal/Wood etc.):** If freshly painted, make sure surface has **cured for at least 7-10 days.** Clean with water and a mild detergent. Next, wipe the surface with Isopropyl Alcohol or Windex. Wipe dry with a lint-free cloth.

INSTALL - CHOOSE WET OR DRY METHOD**WET APPLICATION METHOD**

- Applying the decal wet allows the decal to be moved around and positioned perfectly on intended area. The decal will not stick to itself when wet, making it easier to handle during the installation. It can be removed and reapplied as needed. Any bubbles that are trapped under the decal can easily be pushed out before the decal dries. This minimizes the chance of incorrect installation. If you are unsure of your ability to apply a decal straight or in the right position, this method allows you to move the decal until you are happy with its placement.
- This application method takes longer to install and the decals must dry before they are fully adhered to the application surface. Depending on the temperature and humidity, drying can take up to several hours.

DRY APPLICATION METHOD

- Applying the decal dry utilizes transfer tape to transfer the decal from the backing paper to the application surface, where the decal is simply applied like a sticker. After the decal is applied, the transfer tape is removed to reveal the decal.
- This application method is a quick and easy way to install decals and works good for flat or slightly curved surfaces. This works best for smaller decals and complex/multi-part decals.
- A disadvantage is you only have one chance to apply the decal perfectly and once applied, it cannot be removed without destroying it. You also have a greater chance of trapping air bubbles under the decal.

INSTALL - TOP HINGE DRY METHOD

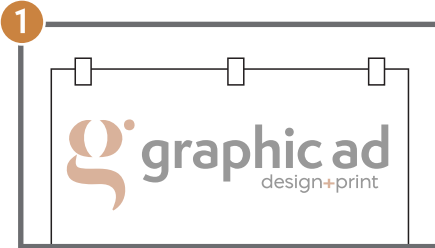

1 Do not remove premask. Use 1" - 2" pieces of masking tape to position the pre-masked vinyl in its places (straight, centered, etc.)

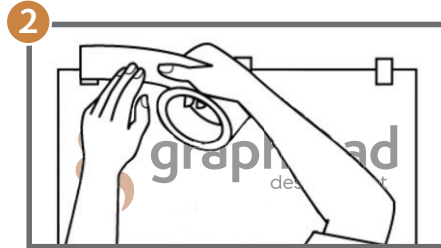

2 Apply a horizontal tape hinge along the top of your pre-masked vinyl. Place tape half on wall and half on decal.

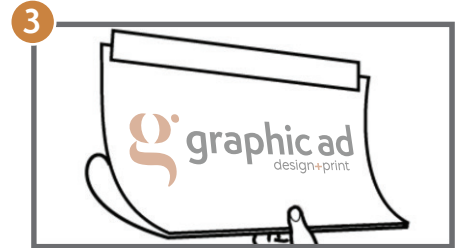

3 Peel the liner half-way and bend it back to meet the edge of the pre-mask. Hold at an angle and keep exposed adhesive off surface.

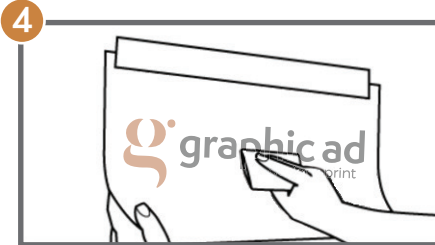

4 Allow vinyl decal to drape. Using firm initial squeegee pressure, start at top of decal and work from center to outside edges of premask. Use slow horizontal overlapping strokes. Continue pulling backing sheet away from premask as you progress to the bottom of the decal.



5 Re-squeegee entire premasked decal. Slowly remove the top layer (premask) by pulling it back on itself at a 45 degree angle (or sharper). Re-squeegee the vinyl once more. Puncture any trapped air pockets with a sharp blade or pin and squeegee from the edge of the pocket to the puncture point - evacuating any trapped air.

Decal will require 72 hours for adhesive to fully set.

DO NOT pressure wash decal until adhesive has fully set.

STORAGE

- Unapplied decals may be stored for up to one year. Decals should be stored in a clean, dry area out of direct sunlight. Ideal storage temperature is 20 degrees Celsius. If possible, lay decals flat to store.

INSTALL - WET METHOD

1 Preparation

Decide where you will be placing your decal and mark surface (we recommend tape or an erasable marking pencil) for placement.



Prepare a mixture of 1L water with approx. 1 tsp of dish soap.

Place decal on table, face down, and remove backing sheet to reveal adhesive.

2



Liberally spray adhesive surface of decal AND the surface you will be applying your decal to with your soapy water.

Apply decal to surface and gently move until you reach your desired placement.

3



Using the supplied squeegee, wrap a paper towel over the edge so as not to scratch the surface of the vinyl. Starting at the middle of your decal, gently but firmly push to remove water from the centre to the outer edges in smooth, even strokes, until you have adhered the entire decal to your surface.

Let set until completely dry before proceeding to the next steps.

4

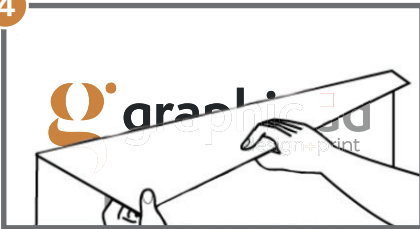

Once decal has dried and there is no moisture remaining, re-squeegee entire decal (if water still leaks from the edges, your decal has not dried completely). Slowly remove the top layer (premask) by pulling back on itself at a 45 degree angle (or sharper). Then re-squeegee the vinyl decal once more and puncture any trapped air pockets with a sharp blade or pin and squeegee from the edge of the pocket to the puncture point - evacuating any trapped water or air.

Decal will require 72 hours for adhesive to fully set - this time starts AFTER decal has fully dried and the process is complete.

DO NOT pressure wash decal until adhesive has fully set.

STORAGE

- Unapplied decals may be stored for up to one year. Decals should be stored in a clean, dry area out of direct sunlight. Ideal storage temperature is 20 degrees Celsius. If possible, lay decals flat to store.

